

Steatite Turbo

STEATITE TECHNOLOGY WATER HEATER WITH FAST HEAT-UP TIME



+ PRODUCT

COMFORT

- Fast heat-up time thanks to 2100 W heating element (heating water up to 30% faster)
- Frontal control knob for the most accurate temperature control
- Flat chromed thermometer

QUALITY - DURABILITY

- Steatite technology: Ceramic dry heating element adapted to aggressive, hard or desalinated water
- Magnesium anode for strengthened tank protection
- New generation diamond-quality enamel (glass-lined inner tank)
- Pressure relief valve
- Dielectric union
- Specific lip gasket to avoid corrosion around flange

USER-FRIENDLINESS

- IP 24 - full compliance with European standards for electrical safety and user protection
- Plug*
- Heating light indicator

SAVINGS

- High-precision bulb thermostat with integrated security
- High-efficiency water inlet
- CFC-free high-density insulation for more energy savings

ELECTRIC WATER HEATER

50 TO 100 L (VERTICAL WALL-MOUNTED)



Model available**



Front control knob



More hot water

MAGNESIUM ANODE

Tank protection



Dry ceramic heating element

Steatite Turbo



- 1 External thermometer
- 2 Diamond-quality enamel (glass-lined inner tank)
- 3 Optimised stainless steel outlet pipe
- 4 Magnesium anode
- 5 High-power Steatite dry heating element
- 6 Inlet diffuser
- 7 Enamelled sleeve
- 8 High-density polyurethane foam 0% CFC
- 9 Frontal control knob
- 10 Dielectric union
- 11 Thermostat



STEATITE
TECHNOLOGY

Thanks to the unique Steatite technology, the water heater is well adapted to aggressive, hard and desalinated water. Ceramic heating element is protected by enamelled steel sleeve, which grants a large heat exchange surface and reduces limescale deposits.

INSTALLATION DIMENSIONS

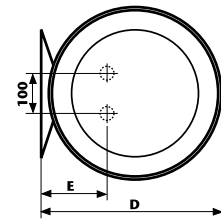
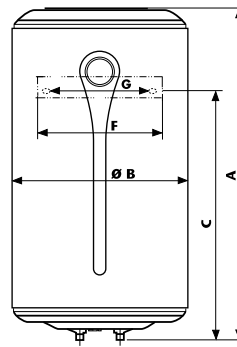

TECHNICAL DATA

CAPACITY (L)	OUTPUT (W)	VOLTAGE (V)	ENERGY CONSUMPTION (kWh/24 h AT 65°C)	HEAT-UP TIME AT 60°C (ΔT=50°C)
50	2100	230 (220/240)	0.95	1h19
80	2100	230 (220/240)	1.35	2h22
100	2100	230 (220/240)	1.7	3h09

DIMENSIONS

CAPACITY (L)	DIMENSIONS (mm)							FLANGE OPENING (Ø) mm	NET WEIGHT (Kg)	ERP ENERGY CLASS	PROFILE
	A	B	C	D	E	F	G				
50	629	433	395	451	158	300	239	72	15	C	M
80	876	433	605	451	158	300	239	72	21	C	L
100	1038	433	755	451	158	300	239	72	24	C	L